

Products and Solutions

To Measure, Monitor and Control



Flow



Pressure

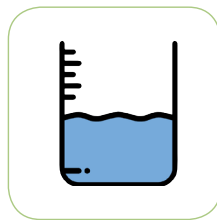

Level



Temperature



Analytical

For The Process Industries

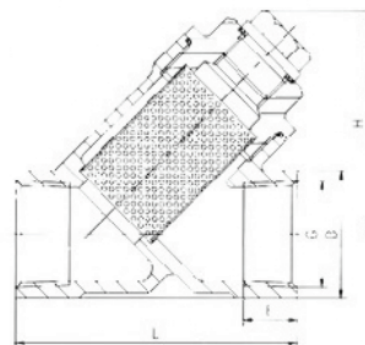

Material Specifications

Material Name	SY11-(16-64)C	SY11-(16-64)P	SY11-(16-64)R
Body	WCB	ZG1Cr18Ni9Ti CF8	ZG1Cr18Ni12Mo2Ti CF8M
Bonnet	WCB	ZG1Cr18Ni9Ti CF8	ZG1Cr18Ni12Mo2Ti CF8M
Mesh	1Cr18Ni9Ti 304	1Cr18Ni9Ti 304	1Cr18Ni12Mo2Ti 316
Gasket	Polytetrafluorethylene (PTFE)		

Specifications

Technical specification	
Nominal pressure	PN1.6, 2.5, 4.0, 6.4MPa
Strength testing pressure	PT2.4, 3.6, 6.0, 9.6MPa
Seat testing pressure(high pressure)	1.8, 2.8, 4.4, 7.1MPa
Applicable medium	SY11-(16-64)C Water, Oil, Gas
Suitable temperature	-29~180°C
Applicable medium	SY11-(16-64)P Nitric acid SY11-(16-64)R Acetic acid

Main external and connecting dimensions(mm)

DN	G	L	E	B	H
8	1/4"	64	12	24	44
10	3/8"	64	12	24	44
15	1/2"	64	14	28	44
20	3/4"	75	15	32	52
25	1"	89	17	41	64
32	1 1/4"	102	20	49	68
40	1 1/2"	118	20	56	76
50	2"	139	22	69	88
65	2 1/2"	180	28	84	110
80	3"	200	32	98	135

AE DIN-CAST IRON STRAINER

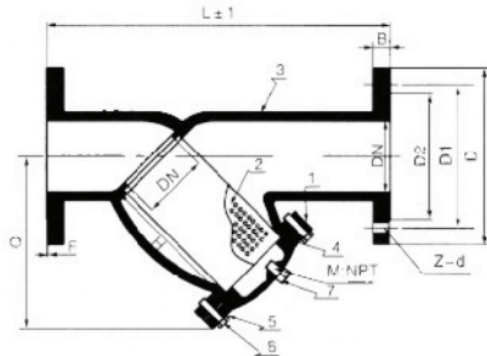

Product Overview

Y strainer belongs to pipeline coarse filter it can filter big PM in fluid, air or other media. It was installed on the pipeline to remove larger solid impurity in fluid, so that the machinery equipment (include compressor and pump etc), instrument can work and operate normally to steady technology and guarantee safety production. When the fluid enter into certain size screen, the impurity was stopped, and the clean filtrate will be discharged from strainer exit. When it was cleaned, as long as knock down screen, reload after handling, so the use and maintenance is very convenient.

Material Specifications

NO.	Parts	Material
1	Bonnet	DI, CI
2	Screen	SS304
3	Body	DI, CI
4	Bonnet Gasket	NBR
5	Gasket	SS304
6	Bolt	SS304
7	Plug	Carbon Steel

Valve design

Technical specification	
Face to Face	DIN3202-F1
Flange Drilling	DIN2532/DIN2533
Pressure	PN10/PN16

Main external and connecting dimensions(mm)

DN	D		D1	D2	L	B	F	Z-d		M	Q	
	PN10/16							PN10	PN16			
15	Φ90		Φ65	Φ45	130	14	3	4-Φ14	4-Φ14		63	
20	Φ95		Φ75	Φ58	150	16	3	4-Φ14	4-Φ14		70	
25	Φ105		Φ85	Φ68	160	16	3	4-Φ14	4-Φ14		73	
32	Φ115		Φ100	Φ78	180	18	3	4-Φ19	4-Φ19		108	
40	Φ150		Φ110	Φ88	200	19	3	4-Φ19	4-Φ19		130	
50	Φ165		Φ125	Φ102	230	19	3	4-Φ19	4-Φ19	3/8	135	
65	Φ185		Φ145	Φ122	290	19	3	4-Φ19	4-Φ19	3/8	156	
80	Φ200		Φ160	Φ138	310	19	3	8-Φ19	8-Φ19	3/8	176	
100	Φ220		Φ180	Φ158	350	19	3	8-Φ19	8-Φ19	3/8	205	
125	Φ250		Φ210	Φ188	400	19	3	8-Φ19	8-Φ19	3/8	245	
150	Φ285		Φ240	Φ212	480	19	3	8-Φ23	8-Φ23	3/4	303	
200	Φ340		Φ295	Φ268	600	20	3	8-Φ23	12-Φ23	3/4	399	
250	Φ405	Φ350	Φ355	Φ320	730	22	3	12-Φ23	12-Φ27	3/4	469	
300	Φ460	Φ400	Φ410	Φ370	Φ378	850	24.5	4	12-Φ23	12-Φ27	3/4	537
350	Φ520	Φ460	Φ470	Φ430	Φ438	980	30	4	12-Φ23	12-Φ27	3/4	630
400	Φ580	Φ515	Φ525	Φ480	Φ487	1100	32	4	12-Φ23	12-Φ30	3/4	537

AE ANSI-CAST IRON STRAINER

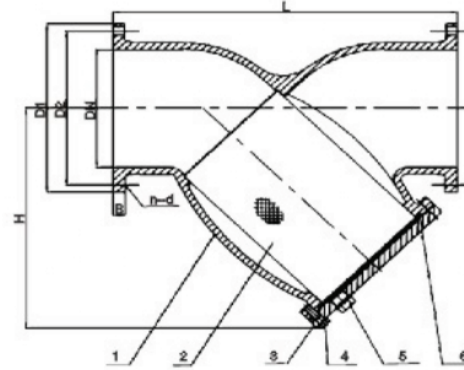

Material Specifications

NO.	Parts	Material
1	Bonnet	DI, CI
2	Screen	SS304
3	Body	DI, CI
4	Bonnet Gasket	NBR
5	Gasket	SS304
6	Bolt	SS304
7	Plug	Carbon Steel

Valve design

Technical specification	
Face to Face	DIN3202-F1
Flange Drilling	DIN2532/DIN2533
Pressure	PN10/PN16

Main external and connecting dimensions(mm)

DN	L	D1	D2	B		n-d	H
				125LB	150LB		
2"	225	152	121	15.8	19	4-19	151
2.5"	273	178	139.5	17.8	22	4-19	189
3"	292	190	152.5	19	24	4-19	214
4"	352	228	190.5	24	24	8-19	226
5"	416	254	215.9	24	24	8-22.4	273
6"	470	279	241.5	25.4	25.4	8-22.4	301
8"	543	342	298.5	28.5	28.5	8-22.4	370
10"	660	406	362	30	30	12-25.4	457
12"	762	483	432	31.8	31.8	12-25.4	540
14"	980	520	476	35	35	12-29	740
16"	1100	580	539.5	36.6	36.6	16-29	850
18"	1200	640	578	39.6	39.6	16-32	850

AE BS STRAINER

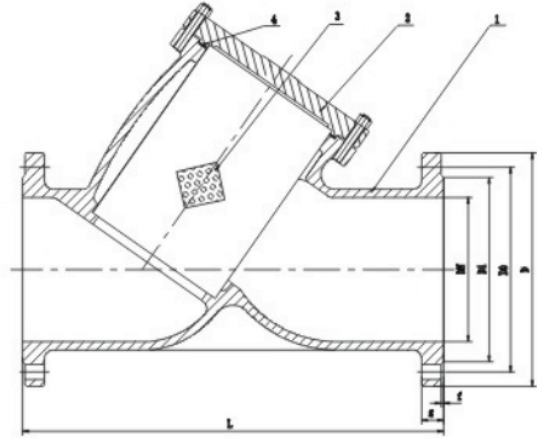

Material Specifications

No.	Parts	Material
1	Body	CI, DI, WCB
2	Screen	304
3	Shim	PTFE
4	Bonnet	CI, DI, WCB

Valve design

Technical specification	
Valve Design	BS5153, EN13709
Face to Face	EN558
Flange Drilling	BS4504/EN1092-2

AE BS STRAINER

Main external and connecting dimensions(mm)

PN16

DN	L	D	D1	D2	b	f	Z-Φd	H
50	215	165	125	100	16	3	4-19	155
65	250	185	145	120	18	3	4-19	170
80	285	200	160	135	20	3	8-19	185
100	300	220	180	155	20	3	8-19	220
125	350	250	210	185	22	3	8-19	260
150	385	285	240	210	24	3	12-23	350
200	490	340	295	265	26	3	12-28	370
250	550	405	355	320	30	3	12-28	430
300	620	460	410	375	30	4	12-28	465
350	685	520	470	435	34	4	16-28	550
400	785	580	525	485	36	4	16-31	610
450	850	640	585	545	40	4	20-31	725
500	900	715	650	608	44	4	20-34	750
600	1080	840	770	718	48	5	20-37	950
700	1200	910	840	788	50	5	24-36	1250
800	1400	1025	950	898	52	5	24-39	1400
900	1650	1125	1050	998	54	5	28-39	1500
1000	2000	1255	1170	1110	56	5	28-42	1800
1200	2200	1485	1390	1325	58	5	32-48	2000
1400	2500	1685	1590	1525	60	5	36-48	2200
1500	2700	1785	1690	1625	60	5	36-48	2400

PN25

DN	L	D	D1	D2	b	f	Z-Φd	H
50	225	165	125	100	20	3	4-19	155
65	265	185	145	120	22	3	8-19	170
80	285	200	160	135	22	3	8-19	185
100	305	235	190	160	24	3	8-22	220
125	355	270	220	188	28	3	8-26	260
150	385	300	250	218	30	3	8-26	350
200	490	360	310	278	34	3	12-26	370
250	550	425	370	332	36	3	12-30	430
300	620	485	430	390	40	4	16-30	465
350	685	555	490	448	44	4	16-33	550
400	785	620	550	505	48	4	16-36	610
450	850	670	600	555	50	4	20-36	725
500	900	730	660	610	52	4	20-36	750
600	1080	845	770	718	56	5	20-39	950
700	1200	960	875	815	60	5	24-42	1250
800	1400	1085	990	930	64	5	24-48	1400
900	1650	1185	1090	1025	66	5	28-48	1500
1000	2000	1320	1210	1140	68	5	28-56	1800
1200	2200	1530	1420	1350	72	5	32-56	2000
1400	2500	1755	1640	1560	75	5	36-60	2200
1500	2700	1855	1740	1650	75	5	36-62	2400

AE WATER OUTLET STRAINER

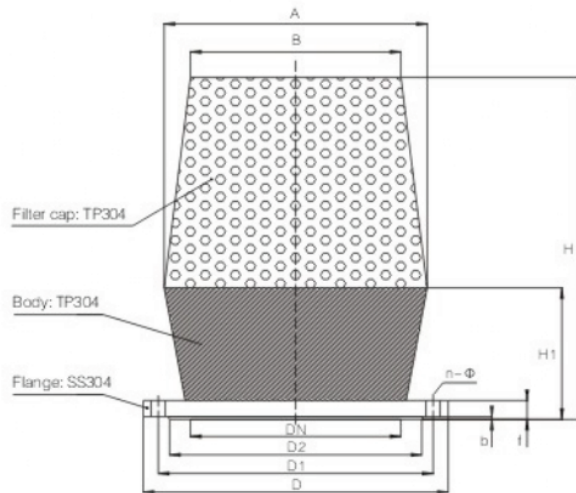

Function

Water outlet strainer is an indispensable device on the medium pipeline, usually installed in the pressure relief valve, pressure relief valve, constant water level valve, square filter other equipment inlet equipment. The filter has a certain size of filter mesh filter cylinder, its impurities are blocked, when the need to clean, as long as the removable filter cylinder out, after treatment can be reloaded, therefore, the use and maintenance is very convenient.

Main Sizes and Dimensions

Outline size					Connection flange size PN 1.6MPa					
DN	A	B	H	H1	D	D1	D2	b	f	n-Φ
100	120	100	200	60	215	180	155	20	3	8-18
125	150	125	250	80	245	210	185	22	3	8-18
150	180	150	300	100	280	240	210	24	3	8-22
200	250	200	300	100	335	295	265	26	3	12-22
250	300	250	400	150	405	335	320	30	3	12-25
300	360	300	500	200	460	410	375	30	4	12-25
350	420	350	550	250	520	470	435	34	4	16-25
400	500	400	650	250	580	525	485	36	4	16-30
450	540	450	650	250	640	585	545	40	4	20-30
500	600	500	800	300	705	650	608	44	4	20-34
600	720	600	800	300	840	770	718	48	5	24-41
700	840	700	900	400	910	840	788	50	5	24-41
800	960	800	1000	400	1020	950	898	52	5	24-41

AE JIS-CAST IRON STRAINER

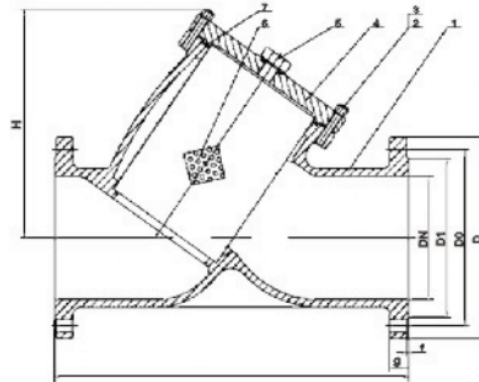

Material Specifications

NO.	Parts	Material
1	Body	GG GS-C25, CF8, CF8M
2	Bolt	A193-B7, A193-B8
3	Nut	A1942H, A194-8
4	Bonnet	GG GS-C25, CF8, CF8M
5	Plug Screw	S.S 304
6	Screen	S.S 304
7	Gasket	Flexible Graphite+304

Valve design

Technical specification	
Valve design	DIN EN13709-2003
Face to Face	DIN EN588-1:1995
Flange Drilling	DIN EN1092-1:2002
Pressure test	DIN EN12266:2003

Main Sizes and Dimensions

Nominal diameter DN	PN16								PN25								PN40							
	L	D	Do	D1	g	f	n x d	H	L	D	Do	D1	g	f	n x d	H	L	D	Do	D1	g	f	n x d	H
15	130	95	65	45	16	2	4 x 14	85	130	95	65	45	16	2	4 x 14	85	130	95	65	45	16	2	4 x 14	85
20	150	105	75	58	18	2	4 x 14	95	150	105	75	58	18	2	4 x 14	95	150	105	75	58	18	2	4 x 14	95
25	160	115	85	68	18	2	4 x 14	110	160	115	85	68	18	2	4 x 14	110	160	115	85	68	18	2	4 x 14	110
32	180	140	100	78	18	2	4 x 18	125	180	140	100	78	18	2	4 x 18	125	180	140	100	78	18	2	4 x 18	125
40	200	150	110	88	18	3	4 x 18	145	200	150	110	88	18	3	4 x 18	145	200	150	110	88	18	3	4 x 18	145
50	230	165	125	102	18	3	4 x 18	155	230	165	125	102	20	3	4 x 18	155	230	165	125	102	20	3	4 x 18	155
65	290	185	145	122	18	3	8 x 18	175	290	185	145	122	22	3	8 x 18	175	290	185	145	122	22	3	8 x 18	175
80	310	200	160	138	20	3	8 x 18	210	310	200	160	138	24	3	8 x 18	210	310	200	160	138	24	3	8 x 18	210
100	350	220	180	158	20	3	8 x 18	230	350	235	190	162	24	3	8 x 22	230	350	235	190	162	24	3	8 x 18	230
125	400	250	210	188	22	3	8 x 18	270	400	270	220	188	26	3	8 x 26	270	400	270	220	188	26	3	8 x 18	270
150	480	285	240	212	22	3	8 x 22	300	480	300	250	218	28	3	8 x 26	300	480	300	250	218	28	3	8 x 26	300
200	600	340	295	268	24	3	12 x 22	385	600	360	310	278	30	3	12 x 26	385	600	375	220	285	34	3	12 x 30	385
250	730	405	355	320	26	3	12 x 26	535	730	425	370	335	32	3	12 x 30	535	730	450	385	345	38	3	12 x 33	535
300	850	460	410	378	28	4	12 x 26	680	850	485	430	395	34	4	12 x 30	680	850	515	450	410	42	4	16 x 33	680
350	900	520	470	428	30	4	16 x 26	-	900	555	490	450	38	4	16 x 33	-	900	580	510	465	46	4	16 x 36	-
400	1100	580	525	490	32	4	16 x 30	-	1100	620	550	505	40	4	16 x 36	-	1100	660	585	535	50	4	16 x 39	-

AE ANSI-CAST STEEL/STAINLESS STEEL STRAINER

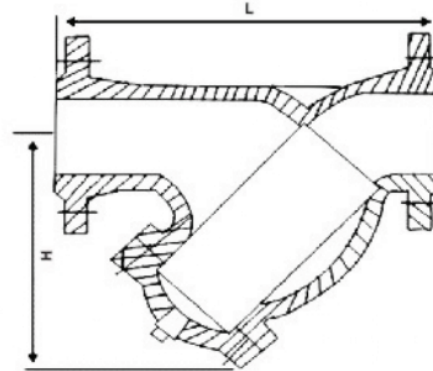

Main connection dimensions

NPS	DN	150Lb						300Lb						600Lb					
		L	D	d	f	K	N-Φ	L	D	d	f	K	N-Φ	L	D	d	F	K	N-Φ
1/2	15	108	90	35		60.5	4-16	152	95	35		60.5	4-16	165	95	35		66.5	4-16
3/4	20	117	100	43		70	4-16	178	120	43		82.5	4-18	190	120	43		82.5	4-18
1	25	127	110	51		79.5	4-16	203	125	51		89	4-18	216	125	51		89	4-18
1 1/4	32	140	120	63.5		89	4-16	216	135	63.5		98.5	4-18	228	135	63.5		98.5	4-18
1 1/2	40	165	130	73		98.5	4-16	229	155	73		114.5	4-22	241	155	73		114.5	4-22
2	50	203	150	92		120.5	4-18	267	165	92		127	8-18	292	165	92		127	8-18
2 1/2	65	216	180	105		139.5	4-18	292	190	105		149	8-22	330	190	105		149	8-22
3	80	241	190	127		152.5	4-18	318	210	127		168.5	8-22	356	210	127		168.5	8-22
4	100	292	230	157.5		190.5	8-18	356	255	157.5		200	8-22	432	275	157.5		216	8-26
5	125	356	255	186		216	8-22	400	280	186		235	8-22	508	330	186		267	8-29.5
6	150	406	280	216		241.5	8-22	444	320	216		270	12-22	559	355	216		292	12-29.5
8	200	495	345	270	1.6	298.5	8-22	533	380	270	1.6	330	12-26	660	420	270	6.4	349	12-32.5
10	250	622	405	324		362	12-26	622	445	324		387.5	16-29.5	787	510	324		432	16-35.5
12	300	698	485	381		432	12-26	711	520	381		451	16-32.5	838	560	381		489	20-35.5
14	350	787	535	413		476	12-29.5	838	585	413		514.5	20-32.5	889	605	413		527	20-39
16	400	914/864	600	470		540	16-29.5	864	650	470		571.5	20-35.5	991	685	470		603	20-42
18	450	978	635	533.5		578	16-32.5	978	710	533.5		628.5	24-35.5	1092	745	533.5		654	20-45
20	500	978	700	584		635	20-32.5	1016	775	584		686	24-35.5	1194	815	584		724	24-45
22	550	1067	750	641		692	20-35.5	1118	840	641		743	24-42	1295	870	641		778	24-48
24	600	1295	815	692		749.5	20-35.5	1346	915	692		813	24-42	1397	940	692		838	24-51
26	650	1295	786	711		745	36-22	1346	867	737		803	32-35.5						
28	700	1448	837	762		795	40-22	1499	921	787		857	36-35.5						
30	750	1524	887	813		846	44-22	1594	991	845		921	36-39						

AE JIS-CAST STEEL/STAINLESS STEEL STRAINER

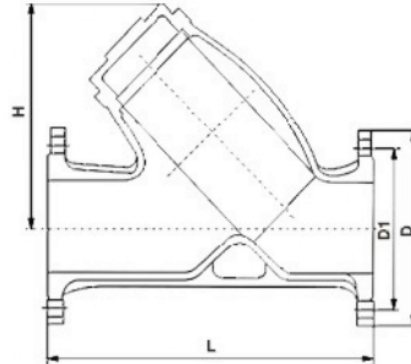

Material Specifications

NO.	Parts	Material
1	Body	A216 WCB, A352 LCB, A351 CF8, A351 CF8M, A351 CF3M
2	Corer	A216 WCB, A352 LCB, A351 CF8, A351 CF8M, A351 CF3M
3	Plug	A351 CF8, A276 304
4	Screen	A241 304
5	Gasket	304+Graphite
6	Bolt	A193 B7, A193 B8, A307 B
7	Nut	A194 2H, A194, 8

Valve design

Technical specification	
Valve design	JIS B2074 B2081
Face to Face	JIS B2072 B2084
Flange Drilling	JIS B2212 B2214
Pressure test	JIS B2003

Main external and connecting dimensions

Size	in	2 1/2"	3"	4"	5"	6"	8"	10"	12"
	mm	65	80	100	125	150	200	250	300
10K ST(BB)	L	285	302	377	392	442	540	668	762
	H	165	200	215	257	305	410	490	580
	D	175	185	210	250	280	330	400	450
	D1	140	150	175	210	240	290	355	400

Main external and connecting dimensions

Size	in	1/2"	3/4"	1"	1 1/4"	1 1/2"	2"	2 1/2"	3"	4"
	mm	15	20	25	32	40	50	65	80	100
10K ST(FT)	L	120	125	155	170	182	200	268	287	340
	H	70	77	82	95	102	125	140	183	212



AE ANDERSON
EUROTECH
VALVES AND INSTRUMENTS

For Your Sales and After Sales, please contact:

Indonesia Sole Distributor

PT. Multi Sukses Pratama

Jl. Bandengan Utara No. 80
Rukan Bandengan Indah D No.20

Jakarta Utara, Indonesia

☎ (62) (21) 29379590, 29379591, 68292838, 8822918 (62)

☎ (21) 29379571

E-mail: sales@suksespratama.com